

## Green Jade



Make it yourself with **Makin's Clay™**!

Designed by **Greensward** Design Team

**Skill Level** - Easy

**Time to Complete** - 1/2 hours  
(Does not include drying time)

### Supplies:

#### \* Makin's Clay™ - The No Bake Clay™

- \* No Kneading, conditioning, or baking required!
- 60g Natural clay
- 60g Green clay

### Recommended Tools:

- **Makin's Brand™** Chisel



### Other Materials:

- Acrylic Paint: Kelly Green # DA055 (Americana® Acrylic Paint)
- Acrylic Paint: Hauser Light Green # DA131 (Americana® Acrylic Paint)
- Acrylic Paint: Black Forest Green # DA83(Americana® Acrylic Paint)
- Chinese Style Rubber Stamp
- Silver Ring
- Red Rope
- Glue (We recommend Crafter's Pick™ Incredibly Tacky)

**1.** Marbleize acrylic paint Kelly Green #DA055 and Hauser Light Green #DA131 with Natural clay to form a 30mm diameter, 8mm thick Light Green round clay piece.



**2.** Mix acrylic paint Black Forest Green with Green clay to form Dark Green clay, take a small portion of Dark Green clay and marbleize it with the Light Green round pendant. Press the Chinese style rubber stamp on the surface of the pendant and use the **Makin's Brand™** Chisel to make a hole at the center.

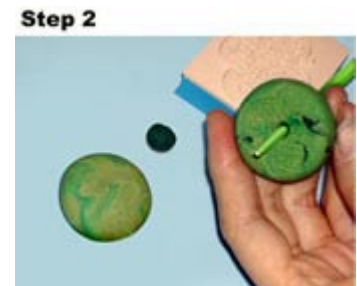

**3.** Form a 13mm diameter clay ball by marbleize acrylic paint Kelly Green #DA055 and Hauser Light Green #DA131 with Natural clay, then add a small portion of Dark Green clay to it and flatten one side a bit to fit the base of the ring, attach and secure by glue.



**F**inal. Hang the pendant on the red rope and knot.

